



**CODO 90° HEMBRA-HEMBRA**  
**FIG. 305**

	MEDIDA	REFERENCIA
	1/4"	AF0000305014
	3/8"	AF0000305038
	1/2"	AF0000305012
	3/4"	AF0000305034
	1"	AF0000305100
	1 1/4"	AF0000305114
	1 1/2"	AF0000305112
	2"	AF0000305200

**TE IGUAL HEMBRA**  
**FIG. 315**

	MEDIDA	REFERENCIA
	1/4"	AF0000315014
	3/8"	AF0000315038
	1/2"	AF0000315012
	3/4"	AF0000315034
	1"	AF0000315100
	1 1/4"	AF0000315114
	1 1/2"	AF0000315112
	2"	AF0000315200

**MANGUITO MACHO-MACHO**  
**FIG. 350**

	MEDIDA	REFERENCIA
	1/4"	AF0000350014
	3/8"	AF0000350038
	1/2"	AF0000350012
	3/4"	AF0000350034
	1"	AF0000350100
	1 1/4"	AF0000350114
	1 1/2"	AF0000350112
	2"	AF0000350200

**MANGUITO PLANO-MACHO**  
**FIG. 351**

	MEDIDA	REFERENCIA
	1/4"	AF0000351014
	3/8"	AF0000351038
	1/2"	AF0000351012
	3/4"	AF0000351034
	1"	AF0000351100
	1 1/4"	AF0000351114
	1 1/2"	AF0000351112
	2"	AF0000351200

**MAMELON HEXAGONAL**  
**FIG. 355**

	MEDIDA	REFERENCIA
	1/4"	AF0000355014
	3/8"	AF0000355038
	1/2"	AF0000355012
	3/4"	AF0000355034
	1"	AF0000355100
	1 1/4"	AF0000355114
	1 1/2"	AF0000355112
	2"	AF0000355200

**TAPON MACHO CABEZA HEXAGONAL**  
**FIG. 370**

	MEDIDA	REFERENCIA
	1/4"	AF0000370014
	3/8"	AF0000370038
	1/2"	AF0000370012
	3/4"	AF0000370034
	1"	AF0000370100
	1 1/4"	AF0000370114
	1 1/2"	AF0000370112
	2"	AF0000370200

**TUERCA UNION HEMBRA-HEMBRA**  
**FIG. 325**

	MEDIDA	REFERENCIA
	1/4"	AF0000325014
	3/8"	AF0000325038
	1/2"	AF0000325012
	3/4"	AF0000325034
	1"	AF0000325100
	1 1/4"	AF0000325114
	1 1/2"	AF0000325112
	2"	AF0000325200

**TUERCA UNION MACHO-HEMBRA. FIG.**  
**330**

	MEDIDA	REFERENCIA
	1/4"	AF0000330014
	3/8"	AF0000330038
	1/2"	AF0000330012
	3/4"	AF0000330034
	1"	AF0000330100
	1 1/4"	AF0000330114
	1 1/2"	AF0000330112
	2"	AF0000330200

**REDUCCION HEXAGONAL  
MACHO NPT – MACHO NPT  
FIG. 360**



MEDIDA A	MEDIDA B	REFERENCIA
3/8"	1/4"	AF0000360038
1/2"	3/8"	AF0000360012
3/4"	1/2"	AF0000360034
1"	3/4"	AF0000360100
1 1/4"	1"	AF0000360114
1 1/2"	1 1/4"	AF0000360112
2"	1 1/2"	AF0000360200

**REDUCCION HEXAGONAL  
HEMBRA NPT - MACHO NPT  
FIG. 390**



MEDIDA H	MEDIDA M	REFERENCIA
1/2"	3/8"	AF0000390012
1"	3/4"	AF0000390100

**REDUCCION HEXAGONAL  
MACHO NPT – HEMBRA NPT  
FIG. 385**



MEDIDA M	MEDIDA H	REFERENCIA
1/2"	1/4"	AF0000385013
3/4"	1/2"	AF0000385034
1"	3/4"	AF0000385100
1 1/4"	1/2"	AF0000385107
1 1/4"	1"	AF0000385114
1 1/2"	1/2"	AF0000385109
1 1/2"	3/4"	AF0000385110
1 1/2"	1"	AF0000385111
1 1/2"	1 1/4"	AF0000385112
2"	1 1/2"	AF0000385113

**SEMI-MANGUITO  
HEMBRA NPT – SOLDAR NPT  
FIG.340**



MEDIDA	REFERENCIA
1/8"	AF0000340018
1/4"	AF0000340014
3/8"	AF0000340038
1/2"	AF0000340012
3/4"	AF0000340034
1"	AF0000340100
1 1/4"	AF0000340114
1 1/2"	AF0000340112
2"	AF0000340200

**TAPON  
HEMBRA NPT  
FIG. 365**



MEDIDA	REFERENCIA
1/4"	AF0000365014
3/8"	AF0000365038
1/2"	AF0000365012
3/4"	AF0000365034
1"	AF0000365100
1 1/4"	AF0000365114
1 1/2"	AF0000365112
2"	AF0000325200

**SEMIMANGUITO  
HEMBRA NPT – HEMBRA NPT  
FIG. 335**



MEDIDA	REFERENCIA
1/4"	AF0000335014
3/8"	AF0000335038
1/2"	AF0000335012
3/4"	AF0000335034
1"	AF0000335100
1 1/4"	AF0000335114
1 1/2"	AF0000335112
2"	AF0000335200

**ACCESORIOS ANSI PARA SOLDAR (ANSI B 16.11 SOCKET WELDING FITTINGS).**

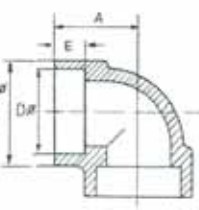
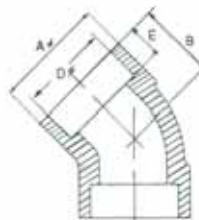
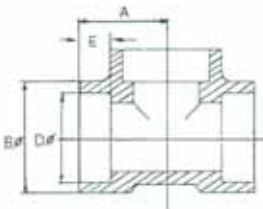
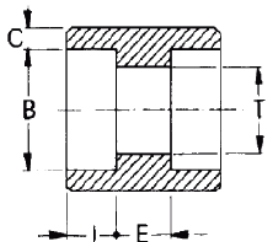
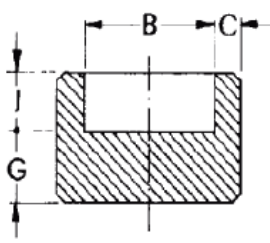
<b>CODO 90° SERIE 3000lbs</b>	<b>DN</b>	<b>A (mm)</b>	<b>Ø B (mm)</b>	<b>Ø D (mm)</b>	<b>E (mm)</b>	<b>REFERENCIA</b>
 <p>CODOS 90° (90° ELBOWS)</p>	1/2"	28,5	33,5	21,7	12,5	AFCOD90SW012
	3/4"	33,5	38,0	27,1	14,5	AFCOD90SW034
	1"	38,0	46,0	33,8	16,0	AFCOD90SW100
	1 1/4"	44,5	55,5	42,6	17,5	AFCOD90SW114
	1 1/2"	51,0	62,0	48,7	19,0	AFCOD90SW112
	2"	60,5	75,7	61,1	22,0	AFCOD90SW200
	2 1/2"	76,0	92,0	73,8	34,5	AFCOD90SW212
	3"	86,0	110,0	89,8	29,0	AFCOD90SW300
	4"	114,5	152,5	115,4	48,0	AFCOD90SW400
<b>CODO 45° SERIE 3000lbs</b>	<b>DN</b>	<b>A (mm)</b>	<b>Ø B (mm)</b>	<b>Ø D (mm)</b>	<b>E (mm)</b>	<b>REFERENCIA</b>
 <p>CODOS 45° (45° ELBOWS)</p>	1/2"	38,0	25,5	21,7	11,0	AFCOD45SW012
	3/4"	38,0	25,5	27,1	12,5	AFCOD45SW034
	1"	46,0	28,5	33,8	14,5	AFCOD45SW100
	1 1/4"	55,5	33,5	42,6	16,0	AFCOD45SW114
	1 1/2"	62,0	35,0	48,7	16,0	AFCOD45SW112
	2"	75,5	43,0	61,1	17,5	AFCOD45SW200
	2 1/2"	101,5	52,5	73,8	24,0	AFCOD45SW212
	3"	118,0	63,5	89,8	32,0	AFCOD45SW300
	4"	146,0	79,5	115,4	38,0	AFCOD45SW400
<b>TE SERIE 3000lbs</b>	<b>DN</b>	<b>A (mm)</b>	<b>Ø B (mm)</b>	<b>Ø D (mm)</b>	<b>E (mm)</b>	<b>REFERENCIA</b>
 <p>TES (TEES)</p>	1/2"	28,5	33,5	21,7	12,5	AF000TESW012
	3/4"	33,5	38,0	27,1	14,5	AF000TESW034
	1"	38,0	46,0	33,8	16,0	AF000TESW100
	1 1/4"	44,5	55,5	42,6	17,5	AF000TESW114
	1 1/2"	51,0	62,0	48,7	19,0	AF000TESW112
	2"	60,5	75,7	61,1	22,0	AF000TESW200
	2 1/2"	76,0	92,0	73,8	34,5	AF000TESW212
	3"	86,0	110,0	89,8	29,0	AF000TESW300
	4"	114,5	152,5	115,4	48,0	AF000TESW400
<b>MANGUITO SERIE 3000lbs</b>	<b>DN</b>	<b>C (mm)</b>	<b>Ø B (mm)</b>	<b>J (mm)</b>	<b>Ø T (mm)</b>	<b>REFERENCIA</b>
	1/2"	4,7	21,7	9,7	15,0	AF0MANGSW012
	3/4"	4,9	27,1	12,7	20,2	AF0MANGSW034
	1"	5,7	33,8	12,7	25,9	AF0MANGSW100
	1 1/4"	6,1	42,6	12,7	34,3	AF0MANGSW114
	1 1/2"	6,4	48,7	12,7	40,1	AF0MANGSW112
	2"	6,9	61,1	15,7	51,7	AF0MANGSW200
	2 1/2"	8,8	73,8	15,7	61,2	AF0MANGSW212
	3"	9,5	89,8	15,7	76,4	AF0MANGSW300
	4"	10,7	115,4	19,0	100,7	AF0MANGSW400
<b>CAP SERIE 3000lbs</b>	<b>DN</b>	<b>C (mm)</b>	<b>Ø B (mm)</b>	<b>J (mm)</b>	<b>G (mm)</b>	<b>REFERENCIA</b>
	1/2"	4,7	21,7	9,7	8,0	AF00CAPSW012
	3/4"	4,9	27,1	12,7	10,0	AF00CAPSW034
	1"	5,7	33,8	12,7	11,0	AF00CAPSW100
	1 1/4"	6,1	42,6	12,7	13,0	AF00CAPSW114
	1 1/2"	6,4	48,7	12,7	14,0	AF00CAPSW112
	2"	6,9	61,1	15,7	18,0	AF00CAPSW200
	2 1/2"	8,8	73,8	15,7	21,0	AF00CAPSW212
	3"	9,5	89,8	15,7	24,0	AF00CAPSW300
	4"	10,7	115,4	19,0	30,0	AF00CAPSW400

**ACCESORIOS ANSI PARA SOLDAR (ANSI B 16.9 BUTT-WELDING)**

**CODO 90° RADIO CORTO STANTARD sch40**

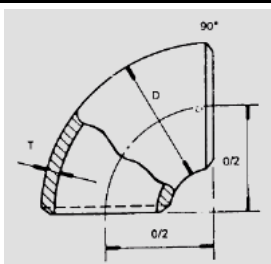
	DN	Ø EXT D (mm)	ESPEJOR T (mm)	RADIO 0/2 (mm)	PESO (kg)	REFERENCIA
	1"	33,4	3,38	25,4	0,104	AFCODCASA100
	1 1/4"	42,2	3,56	31,8	0,180	AFCODCASA114
	1 1/2"	48,3	3,68	38,1	0,300	AFCODCASA112
	2"	60,3	3,91	50,8	0,600	AFCODCASA200
	2 1/2"	73,0	5,16	63,5	0,950	AFCODCASA212
	3"	88,9	5,49	76,2	1,350	AFCODCASA300
	4"	114,3	6,02	101,6	2,700	AFCODCASA400
	6"	168,3	7,11	152,4	7,300	AFCODCASA600

NOTA IMPORTANTE: MATERIAL BAJO PEDIDO

**ACCESORIOS ANSI PARA SOLDAR (ANSI B 16.9 BUTT-WELDING)**

**CODO 90° RADIO LARGO STANTARD sch40**

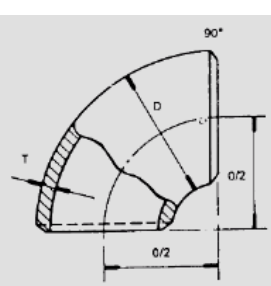
	DN	Ø EXT D (mm)	ESPEJOR T (mm)	RADIO 0/2 (mm)	PESO (kg)	REFERENCIA
	1/2"	21,3	2,77	38,1	0,077	AFCODLASA012
	3/4"	26,7	2,87	28,6	0,077	AFCODLASA034
	1"	33,4	3,38	38,1	0,170	AFCODLASA100
	1 1/4"	42,2	3,56	47,6	0,250	AFCODLASA114
	1 1/2"	48,3	3,68	57,2	0,400	AFCODLASA112
	2"	60,3	3,91	76,2	0,700	AFCODLASA200
	2 1/2"	73,0	5,16	95,2	1,350	AFCODLASA212
	3"	88,9	5,49	114,3	2,200	AFCODLASA300
	4"	114,3	6,02	152,4	4,100	AFCODLASA400
6"	168,3	7,11	228,6	11,00	AFCODLASA600	

**ACCESORIOS ANSI PARA SOLDAR (ANSI B 16.9 BUTT-WELDING)**

**TE IGUAL STANTARD sch40**

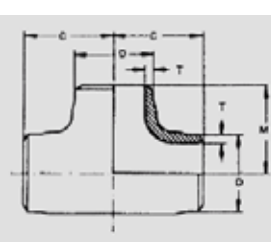
	DN	Ø EXT D (mm)	ESPEJOR T (mm)	C-M (mm)	PESO (kg)	REFERENCIA
	1/2"	21,3	2,77	25,4	0,27	AFTESSASA012
	3/4"	26,7	2,87	25,4	0,31	AFTESSASA034
	1"	33,4	3,38	38,1	0,34	AFTESSASA100
	1 1/4"	42,2	3,56	47,6	0,61	AFTESSASA114
	1 1/2"	48,3	3,68	57,1	0,92	AFTESSASA112
	2"	60,3	3,91	63,5	1,34	AFTESSASA200
	2 1/2"	73,0	5,16	76,2	2,36	AFTESSASA212
	3"	88,9	5,49	85,7	3,38	AFTESSASA300
	4"	114,3	6,02	105	5,72	AFTESSASA400
6"	168,3	7,11	143	13,30	AFTESSASA600	

**ACCESORIOS ANSI PARA SOLDAR (ANSI B 16.9 BUTT-WELDING)**

**CAP STANDARD sch40**

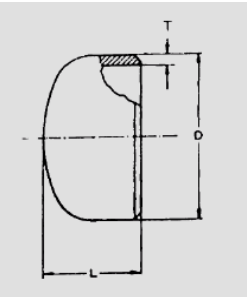
	DN	Ø EXT D (mm)	ESPEJOR T (mm)	LONGITUD A (mm)	PESO (kg)	REFERENCIA
	1/2"	21,3	2,77	25,4	0,032	AFCAPSASA012
	3/4"	26,7	2,87	31,7	0,059	AFCAPSASA034
	1"	33,4	3,38	38,1	0,10	AFCAPSASA100
	1 1/4"	42,2	3,56	38,1	0,14	AFCAPSASA114
	1 1/2"	48,3	3,68	38,1	0,17	AFCAPSASA112
	2"	60,3	3,91	38,1	0,23	AFCAPSASA200
	2 1/2"	73,0	5,16	38,1	0,37	AFCAPSASA212
	3"	88,9	5,49	50,8	0,64	AFCAPSASA300
	4"	114,3	6,02	63,5	1,15	AFCAPSASA400
	6"	168,3	7,11	88,9	1,90	AFCAPSASA600

**ACCESORIOS ANSI PARA SOLDAR (ANSI B 16.9 BUTT-WELDING)**

**REDUCCIONES CONCENTRICAS sch40**

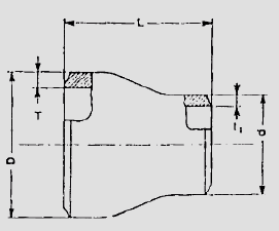
	DN	Ø EXT		ESPEJOR		LONG. L	PESO (kg)	REFERENCIA
		D	d	T	t <sub>1</sub>			
	3/4" x 1/2"	26,67	21,3	2,87	2,77	38,1	0,09	AFRASA034012
	1" x 1/2"	33,4	21,3	3,38	2,77	50,8	0,14	AFRASA100012
	1" x 3/4"	33,4	26,7	3,38	2,87	50,8	0,14	AFRASA100034
	1 1/4" x 1/2"	42,2	21,3	3,56	2,77	50,8	0,20	AFRASA114012
	1 1/4" x 3/4"	42,2	26,7	3,56	2,87	50,8	0,20	AFRASA114034
	1 1/4" x 1"	42,2	33,4	3,56	3,38	50,8	0,20	AFRASA114100
	1 1/2" x 1/2"	48,3	21,3	3,68	2,77	63,5	0,20	AFRASA112012
	1 1/2" x 3/4"	48,3	26,7	3,68	2,87	63,5	0,22	AFRASA112034
	1 1/2" x 1"	48,3	33,4	3,68	3,38	63,5	0,24	AFRASA112100
	1 1/2" x 1 1/4"	48,3	42,2	3,68	3,56	63,5	0,26	AFRASA112114
	2" x 3/4"	60,3	26,7	3,91	2,87	76,2	0,33	AFRASA200034
	2" x 1"	60,3	33,4	3,91	3,38	76,2	0,37	AFRASA200100
	2" x 1 1/4"	60,3	42,2	3,91	3,56	76,2	0,39	AFRASA200114
	2" x 1 1/2"	60,3	48,3	3,91	3,68	76,2	0,41	AFRASA200112
	2 1/2" x 1"	73,0	33,4	5,16	3,38	88,9	0,59	AFRASA212100
	2 1/2" x 1 1/4"	73,0	42,2	5,16	3,56	88,9	0,67	AFRASA212114
	2 1/2" x 1 1/2"	73,0	48,3	5,16	3,68	88,9	0,68	AFRASA212112
	2 1/2" x 2"	73,0	60,3	5,16	3,91	88,9	0,73	AFRASA212200
	3" x 1 1/4"	88,9	42,2	5,49	3,56	88,9	0,77	AFRASA300114
	3" x 1 1/2"	88,9	48,3	5,49	3,68	88,9	0,86	AFRASA300112
	3" x 2"	88,9	60,3	5,49	3,91	88,9	0,91	AFRASA300200
	3" x 2 1/2"	88,9	73,0	5,49	5,16	88,9	0,98	AFRASA300121
	4" x 1 1/2"	114,3	40,3	6,02	3,68	101,6	1,24	AFRASA400112
	4" x 2"	114,3	60,3	6,02	3,91	101,6	1,44	AFRASA400200
	4" x 2 1/2"	114,3	73,0	6,02	5,16	101,6	1,52	AFRASA400212
	4" x 3"	114,3	88,9	6,02	5,49	101,6	1,59	AFRASA400300
	6" x 2 1/2"	168,30	73,0	7,11	5,16	140	3,45	AFRASA600212
	6" x 3"	168,30	88,9	7,11	5,49	140	3,63	AFRASA600300
	6" x 4"	168,30	114,3	7,11	6,02	140	3,72	AFRASA600400

NOTA: COTAS EN mm

**ACCESORIOS DIN PARA SOLDAR**

**CODO 90° RADIO CORTO DIN2605-3D (2448) NORMA 3**

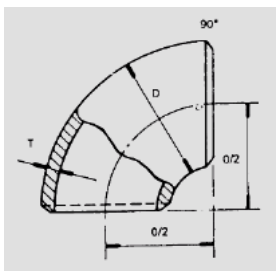
	DN	Ø EXT D (mm)	ESPEJOR T (mm)	RADIO 0/2 (mm)	PESO (kg)	REFERENCIA
	1/2"	21,3	2	28	0,04	AF0CH90N3012
	3/4"	26,7	2,3	29	0,06	AF0CH90N3034
	1"	33,4	2,6	38	0,12	AF0CH90N3100
	1 1/4"	42,2	2,6	48	0,19	AF0CH90N3114
	1 1/2"	48,3	2,6	57	0,26	AF0CH90N3112
	2"	60,3	2,9	76	0,49	AF0CH90N3200
	2 1/2"	73,0	2,9	95	0,78	AF0CH90N3212
	3"	88,9	3,2	114	1,22	AF0CH90N3300
	4"	114,3	3,6	152	2,36	AF0CH90N3400
6"	168,3	4,5	229	6,50	AF0CH90N3600	

**ACCESORIOS DIN PARA SOLDAR**

**CODO 90° RADIO CORTO DIN2605-5D (2448) NORMA 5**

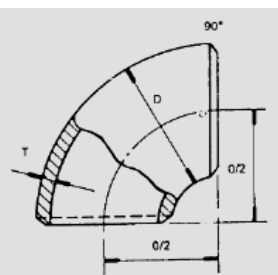
	DN	Ø EXT D (mm)	ESPEJOR T (mm)	RADIO 0/2 (mm)	PESO (kg)	REFERENCIA
	1/2"	21,3	2	42,5	0,07	AF0CH90N5012
	3/4"	26,7	2,3	57,5	0,13	AF0CH90N5034
	1"	33,4	2,6	72,5	0,23	AF0CH90N5100
	1 1/4"	42,2	2,6	92,5	0,37	AF0CH90N5114
	1 1/2"	48,3	2,6	107,5	0,50	AF0CH90N5112
	2"	60,3	2,9	135	0,87	AF0CH90N5200
	2 1/2"	73,0	2,9	175	1,44	AF0CH90N5212
	3"	88,9	3,2	205	2,18	AF0CH90N5300
	4"	114,3	3,6	270	4,17	AF0CH90N5400
6"	168,3	4,5	390	11,1	AF0CH90N5600	

**ACCESORIOS DIN PARA SOLDAR**

**CODO 45° RADIO CORTO DIN2605-3D (2448) NORMA 3**

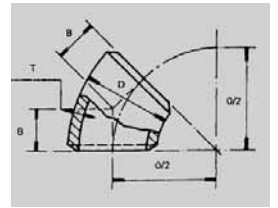
	DN	Ø EXT D (mm)	ESPEJOR T (mm)	RADIO 0/2 (mm)	PESO (kg)	REFERENCIA
	1/2"	21,3	2	28	0,02	AF0CH45N3012
	3/4"	26,7	2,3	29	0,03	AF0CH45N3034
	1"	33,4	2,6	38	0,06	AF0CH45N3100
	1 1/4"	42,2	2,6	48	0,09	AF0CH45N3114
	1 1/2"	48,3	2,6	57	0,13	AF0CH45N3112
	2"	60,3	2,9	76	0,25	AF0CH45N3200

**ACCESORIOS DIN PARA SOLDAR**  
**CAP DIN 28011**

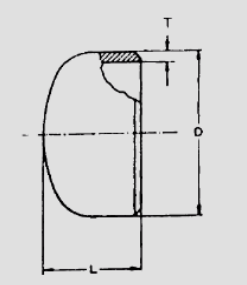
	DN	Ø EXT D (mm)	ESPESOR T (mm)	REFERENCIA
	1/2"	21,3	2	AFCAPSDIN012
3/4"	26,7	2,3	AFCAPSDIN034	
1"	33,4	2,6	AFCAPSDIN100	
1 1/4"	42,2	2,6	AFCAPSDIN114	
1 1/2"	48,3	2,6	AFCAPSDIN112	
2"	60,3	2,9	AFCAPSDIN200	
2 1/2"	73,0	2,9	AFCAPSDIN212	
3"	88,9	3,2	AFCAPSDIN300	
4"	114,3	3,6	AFCAPSDIN400	
6"	168,3	4,5	AFCAPSDIN600	

**ACCESORIOS DIN PARA SOLDAR**  
**REDUCCIONES CONCENTRICAS DIN 2616**

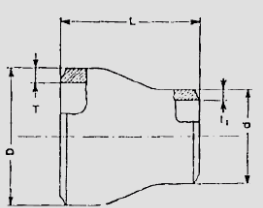
	DN	Ø EXT		ESPESOR		LONG.	PESO	REFERENCIA
		D	d	T	t <sub>1</sub>	L	(kg)	
3/4" x 1/2"	26,67	21,3	2,3	2,0	38,1	0,10	AFRDIN034012	
1" x 1/2"	33,4	21,3	2,6	2,0	50,8	0,10	AFRDIN100012	
1" x 3/4"	33,4	26,7	2,6	2,3	50,8	0,11	AFRDIN100034	
1 1/4" x 3/4"	42,2	26,7	2,6	2,3	50,8	0,14	AFRDIN114034	
1 1/4" x 1"	42,2	33,4	2,6	2,6	50,8	0,15	AFRDIN114100	
1 1/2" x 3/4"	48,3	26,7	2,6	2,3	63,5	0,21	AFRDIN112034	
1 1/2" x 1"	48,3	33,4	2,6	2,6	63,5	0,23	AFRDIN112100	
1 1/2" x 1 1/4"	48,3	42,2	2,6	2,6	63,5	0,23	AFRDIN112114	
2" x 1"	60,3	33,4	2,9	2,6	76,2	0,36	AFRDIN200100	
2" x 1 1/4"	60,3	42,2	2,9	2,6	76,2	0,36	AFRDIN200114	
2" x 1 1/2"	60,3	48,3	2,9	2,6	76,2	0,36	AFRDIN200112	
2 1/2" x 1 1/4"	73,0	42,2	2,9	2,6	88,9	0,55	AFRDIN212114	
2 1/2" x 1 1/2"	73,0	48,3	2,9	2,6	88,9	0,55	AFRDIN212112	
2 1/2" x 2"	73,0	60,3	2,9	2,9	88,9	0,58	AFRDIN212200	
3" x 1 1/2"	88,9	48,3	3,2	2,6	88,9	0,69	AFRDIN300112	
3" x 2"	88,9	60,3	3,2	2,9	88,9	0,72	AFRDIN300200	
3" x 2 1/2"	88,9	73,0	3,2	2,9	88,9	0,72	AFRDIN300121	
4" x 2"	114,3	60,3	3,6	2,9	101,6	1,10	AFRDIN400200	
4" x 2 1/2"	114,3	73,0	3,6	2,9	101,6	1,10	AFRDIN400212	
4" x 3"	114,3	88,9	3,6	3,2	101,6	1,14	AFRDIN400300	
6" x 3"	168,30	88,9	4,5	3,6	140	2,51	AFRDIN600300	
6" x 4"	168,30	114,3	4,5	3,6	140	2,63	AFRDIN600400	

NOTA: Cotas en mm

**DIMENSIONES BRIDAS PLANAS, CON CUELLO PARA SOLDAR A TOPE  
SEGÚN NORMA UNE-EN 1092-1 TIPO 11 (PN16)**

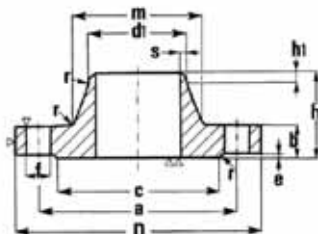

DN	Ø	Ø EXT. CUELLO d <sub>1</sub>	Ø EXT. BRIDA D	ALTURA TOTAL h	GRUESO APROX. B	Ø RESALTO C	ALTURA RESALTO e	Nº AGUJ.	Ø AGUJEROS TORNILLOS f	Ø CIRCULO AGUJEROS a
1/2"	15	20	95	35	14	45	2	4	14	65
3/4"	20	25	105	38	16	58	2	4	14	75
1"	25	30	115	38	16	68	2	4	14	85
1 1/4"	32	38	140	40	16	78	2	4	18	100
1 1/2"	40	44.5	150	42	16	88	3	4	18	110
2"	50	57	165	45	18	102	3	4	18	125
2 1/2"	65	76.1	185	45	18	122	3	4	18	145
3"	80	88.9	200	50	20	138	3	8	18	160
4"	100	108	220	52	20	158	3	8	18	180
5"	125	133	250	55	22	188	3	8	18	210
6"	150	159	285	55	22	212	3	8	22	240
8"	200	219.1	340	62	24	268	3	12	22	295

**DIMENSIONES BRIDAS PLANAS, CON CUELLO PARA SOLDAR A TOPE  
SEGÚN NORMA UNE-EN 1092-1 TIPO 11 (PN40)**

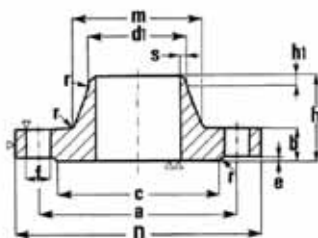

DN	Ø	Ø EXT. CUELLO d <sub>1</sub>	Ø EXT. BRIDA D	ALTURA TOTAL h	GRUESO APROX. B	Ø RESALTO C	ALTURA RESALTO e	Nº AGUJ.	Ø AGUJEROS TORNILLOS f	Ø CIRCULO AGUJEROS a
1/2"	15	20	95	38	16	45	2	4	14	65
3/4"	20	25	105	40	18	58	2	4	14	75
1"	25	30	115	40	18	68	2	4	14	85
1 1/4"	32	38	140	42	18	78	2	4	18	100
1 1/2"	40	44.5	150	45	18	88	3	4	18	110
2"	50	57	165	48	20	102	3	4	18	125
2 1/2"	65	76.1	185	52	22	122	3	8	18	145
3"	80	88.9	200	58	24	138	3	8	18	160
4"	100	108	235	65	24	162	3	8	22	190
5"	125	133	270	68	26	188	3	8	26	220
6"	150	159	300	75	28	218	3	8	26	250
8"	200	219.1	375	88	34	285	3	12	26	320

NOTA: Cotas en mm



**BRIDAS PLANAS CIEGAS PN16 Y PN40**  
**SEGÚN NORMA UNE-EN 1092-1. TIPO 05**

	DN	Ø	REFERENCIA	
			PN 16	PN 40
			1/2"	15
3/4"	20	AF0SR1327034	AFSR13274034	
1"	25	AF0SR1327100	AFSR13274100	
1 1/4"	32	AF0SR1327114	AFSR13274114	
1 1/2"	40	AF0SR1327112	AFSR13274112	
2"	50	AF0SR1327200	AFSR13274200	
2 1/2"	65	AF0SR1327212	AFSR13274212	
3"	80	AF0SR1327300	AFSR13274300	
4"	100	AF0SR1327400	AFSR13274400	
5"	125	AF0SR1327500	AFSR13274500	
6"	150	AF0SR1327600	AFSR13274600	
8"	200	AF0SR1327800	AFSR13274800	

**BRIDAS PLANAS CON CUELLO PARA SOLDAR A TOPE PN16 Y PN40**  
**SEGÚN NORMA UNE-EN 1092-1. TIPO 11**

	DN	Ø	REFERENCIA	
			PN 16	PN 40
			1/2"	15
3/4"	20	AF0SR1333034	AF0SR1335034	
1"	25	AF0SR1333100	AF0SR1335100	
1 1/4"	32	AF0SR1333114	AF0SR1335114	
1 1/2"	40	AF0SR1333112	AF0SR1335112	
2"	50	AF0SR1333200	AF0SR1335200	
2 1/2"	65	AF0SR1333212	AF0SR1335212	
3"	80	AF0SR1333300	AF0SR1335300	
4"	100	AF0SR1333400	AF0SR1335400	
5"	125	AF0SR1333500	AF0SR1335500	
6"	150	AF0SR1333600	AF0SR1335600	
8"	200	AF0SR1333800	AF0SR1335800	

**BRIDAS PLANAS LISAS SIN CUELLO PN10 Y PN40**  
**SEGÚN NORMA UNE-EN 1092-1. TIPO 01**

	DN	Ø	REFERENCIA	
			PN 10	PN 40
			1/2"	15
3/4"	20	AF0BP2576034	AF0002503034	
1"	25	AF0BP2576100	AF0002503100	
1 1/4"	32	AF0BP2576114	AF0002503114	
1 1/2"	40	AF0BP2576112	AF0002503112	
2"	50	AF0BP2576200	AF0002503200	
3"	80	AF0BP2576300	AF0002503300	

**CONJUNTOS BRIDA-RACOR PARA EMBRIDAR APARATOS ROSCADOS**

- MATERIAL: ACERO
- ACABADO: CINCADO

	BRIDA	PN BRIDA	RACOR MACHO	LONGITUD RACOR (SIN ROSCA)	FIG.	REFERENCIA
	DN25	40	¾" GAS	51mm	A	AF40DN25M034
	DN25	40	1" GAS	51mm	A	AF40DN25M100
	DN25	40	1" NPT	51mm	A	AF40DN25M10N
	DN32	40	1" GAS	45mm	-	AF40DN32M100
	DN40	16	1" GAS	45mm	B	AF16DN40M100
	DN40	40	1" GAS	45mm	B	AF40DN40M100
	DN40	16	1½" GAS	60mm	-	AF16DN40M112
	DN40	40	1½" GAS	60mm	C	AF40DN40M112
	DN50	40	1" GAS	38mm	-	AF40DN50M100
	DN50	40	1½" GAS	38mm	-	AF40DN50M112
DN50	40	2" GAS	57mm	-	AF40DN50M200	



FIG. A

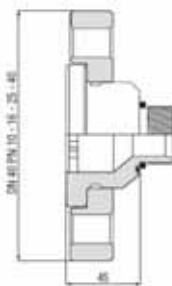

FIG. B



FIG. C

Nota: medidas aproximadas.

**BRIDAS Y RACORES ESPECIALES REGULADORES**

- MATERIAL: ACERO
- ACABADO: CINCADO

FIG.	ENTRADA	SALIDA	PN	ANCHO	REFERENCIA
A	HEMBRA 1" NPT	MACHO 1" GAS	-	28mm	AFH100NM100G
B	DN25	DN25	40	25mm	AF000DN25H14
B	DN40	DN40	40	25mm	AF000DN40H14

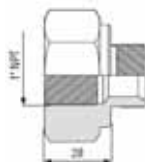

FIG. A

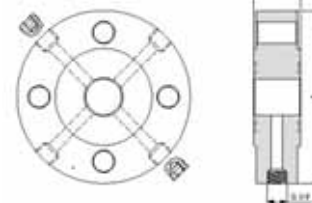
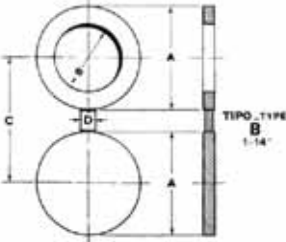



FIG. B

**DIMENSIONES DISCOS EN OCHO PN16 Y PN40**

	DN	Ø	A	B	C	T	M	D
	1/2"	15	45					
	3/4"	20	58					
	1"	25	68	28.6	79.5	6.4	102	25.5
	1 1/4"	32	78	32.0		6.4	102	25.5
	1 1/2"	40	88	41.3	98.5	6.4	102	25.5
	2"	50	102	54.0	121.0	6.4	102	25.5
	2 1/2"	65	122	63.5	140.0	6.4	102	25.5
	3"	80	138	79.4	152.0	6.4	102	25.5
	4"	100	158 (162)	104.8	190.0	6.4	102	25.5
	6"	150	212 (218)	155.6	241.0	9.5	102	25.5
	8"	200	268 (285)	203.2	298.0	12.7	102	25.5

NOTA: ENTRE PARÉNTESIS DIMENSIONES PARA PN40

**DISCOS EN OCHO**

	DN	Ø	REFERENCIA	
			PN 16	PN 40
	1/2"	15	AF00CHODN015	
	3/4"	20	AF00CHODN020	
	1"	25	AF00CHODN025	
	1 1/4"	32	AF00CHODN032	
	1 1/2"	40	AF00CHODN040	
	2"	50	AF00CHODN050	
	2 1/2"	65	AF00CHODN065	
	3"	80	AF00CHODN080	
	4"	100	AF00CHODN100	AFOCHODN4100
	6"	150	AF00CHODN150	AFOCHODN4150
	8"	200	AF00CHODN200	AFOCHODN4200

**JUNTAS PARA BRIDAS DIN**

	DN	Ø	REFERENCIA	
			KLINGER C-4324 (CARTON)	NEOPRENO CR65 (CAUCHO CLOROBUTADIENO)
				1/2"
	3/4"	20	AF0SR1416034	AF0SR65CR034
	1"	25	AF0SR1416100	AF0SR65CR100
	1 1/4"	32	AF0SR1416114	AF0SR65CR114
	1 1/2"	40	AF0SR1416112	AF0SR65CR112
	2"	50	AF0SR1416200	AF0SR65CR200
	2 1/2"	65	AF0SR1416212	AF0SR65CR212
	3"	80	AF0SR1416300	AF0SR65CR300
	4"	100	AF0SR1416400	AF0SR65CR400
	5"	125	AF0SR1416500	AF0SR65CR500
	6"	150	AF0SR1416600	AF0SR65CR600

**TABLA TORNILLERIA PARA BRIDAS + CONTRABRIDAS**

	MEDIDA		BRIDA PN16		BRIDA PN40	
	DN	Ø	NºxMxL	REFERENCIA	NºxMxL	REFERENCIA
		DN10	3/8"	4xM12x50	AN933M12X050	4xM12x50
	DN15	1/2"	4xM12x50	AN933M12X050	4xM12x50	AN933M12X050
	DN20	3/4"	4xM12x50	AN933M12X050	4xM12x60	AN933M12X060
	DN25	1"	4xM12x50	AN933M12X050	4xM12x60	AN933M12X060
	DN32	1 1/4"	4xM16x60	AN933M16X060	4xM16x60	AN933M16X060
	DN40	1 1/2"	4xM16x60	AN933M16X060	4xM16x60	AN933M16X060
	DN50	2"	4xM16x60	AN933M16X060	4xM16x60	AN933M16X060
	DN65	2 1/2"	4xM16x60	AN933M16X060	8xM16x70	AN933M16X070
	DN80	3"	8xM16x60	AN933M16X060	8xM16x70	AN933M16X070
	DN100	4"	8xM16x70	AN933M16X070	8xM20x70	AN933M20X070
	DN125	5"	8xM16x70	AN933M16X070	8xM24x90	AN933M24X090
	DN150	6"	8xM20x70	AN933M20X070	8xM24x90	AN933M24X090
	DN200	8"	12xM20x80	AN933M20X080	12xM27x110	AN933M27X110
	DN250	10"	12xM24x90	AN933M24X090	12xM27x110	AN933M27X110
	DN300	12"	12xM24x90	AN933M24X090	16xM30x120	AN933M30X120

**TABLA TORNILLERIA PARA VALVULAS WAFER + CONTRABRIDA**

	MEDIDA		PN 16		PN 40	
	DN	Ø	Nº x M x L	REFERENCIA	Nº x M x L	REFERENCIA
		DN15	1/2"	4xM12x30	AN933M12X030	4xM12x30
	DN20	3/4"	4xM12x35	AN933M12X035	4xM12x35	AN933M12X035
	DN25	1"	4xM12x35	AN933M12X035	4xM12x35	AN933M12X035
	DN32	1 1/4"	4xM16x35	AN933M16X035	4xM16x35	AN933M16X035
	DN40	1 1/2"	4xM16x35	AN933M16X035	4xM16x35	AN933M16X035
	DN50	2"	4xM16x40	AN933M16X040	4xM16x40	AN933M16X040
	DN65	2 1/2"	4xM16x40	AN933M16X040	8xM16x40	AN933M16X040
	DN80	3"	8xM16x40	AN933M16X040	8xM16x45	AN933M16X045
	DN100	4"	8xM16x45	AN933M16X045	8xM20x50	AN933M20X050
	DN125	5"	8xM16x50	AN933M16X050	8xM22x50	AN933M22X050
	DN150	6"	8xM20x50	AN933M20X050	8xM22x55	AN933M22X055
	DN200	8"	12xM20x50	AN933M20X050	12xM27x65	AN933M27X065

**TORNILLOS CABEZA HEXAGONAL**  
**DIN 933.8 (EN 24017)**

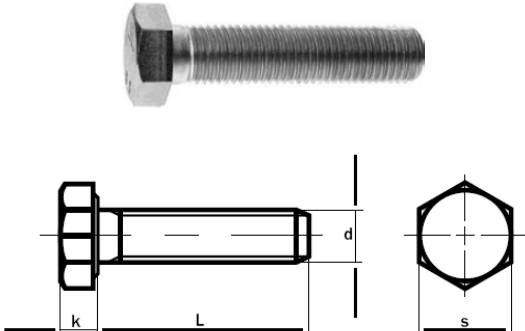
	METRICA	d	L	k	S	REFERENCIA	
	12		12	30	7,5	19	AN933M12X030
		12	35	7,5	19	AN933M12X035	
		12	50	7,5	19	AN933M12X050	
		12	60	7,5	19	AN933M12X060	
		12	120	7,5	19	AN933M12X120	
16			16	35	10	24	AN933M16X035
			16	40	10	24	AN933M16X040
			16	45	10	24	AN933M16X045
			16	50	10	24	AN933M16X050
			16	60	10	24	AN933M16X060
		16	70	10	24	AN933M16X070	
		16	90	10	24	AN933M16X090	
		16	110	10	24	AN933M16X110	
	16	120	10	24	AN933M16X120		
20		20	50	12,5	30	AN933M20X050	
		20	70	12,5	30	AN933M20X070	
		20	80	12,5	30	AN933M20X080	
22		22	50	14	32	AN933M22X050	
		22	55	14	32	AN933M20X055	
24		24	90	15	36	AN933M24X090	
27		27	65	17	41	AN933M27X065	
		27	110	17	41	AN933M27X110	
30		30	120	18,7	46	AN933M30X120	

**TUERCAS HEXAGONALES**  
**DIN 934.8 (EN 24017)**

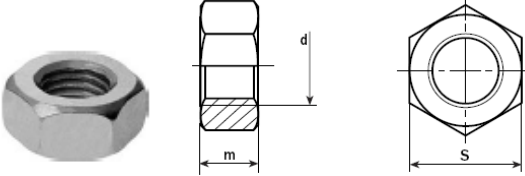
	METRICA	d	m	S	REFERENCIA
		12	12	10	19
	16	16	13	24	AN0DIN934M16
	20	20	16	30	AN0DIN934M20
	24	24	19	36	AN0DIN934M24
	27	27	22	41	AN0DIN934M27
	30	30	24	46	AN0DIN934M30

**ARANDELAS PARA TORNILLOS**  
**DIN 125-AST**

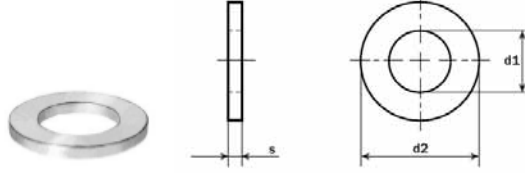
	METRICA	d1	d2	S	REFERENCIA
		12	13	24	2,5
	16	17	30	3	ANDIN125AM16
	20	21	37	3	ANDIN125AM20
	24	25	44	4	ANDIN125AM24
	27	28	50	4	ANDIN125AM27
	30	31	56	4	ANDIN125AM30

**COMPENSADORES DE DILATACIÓN AXIALES ROSCADOS.  
 PARA CALEFACCIÓN, AIRE ACONDICIONADO, A.C.S. Y VAPOR DE BAJA PRESIÓN  
 PRETENSADOS DE FÁBRICA**

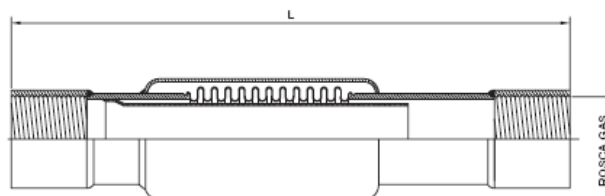

DN	Ø	PN	CARRERA (mm)	L (mm)	REFERENCIA
½"	15	16	-30	300	AF0001016012
¾"	20	16	-30	304	AF0001016034
1"	25	16	-30	320	AF0010160100
1 ¼"	32	16	-30	336	AF0001016114
1 ½"	40	16	-30	336	AF0001016112
2"	50	16	-30	384	AF0001016200

**COMPENSADORES DE DILATACIÓN AXIALES CON BRIDAS.  
 PARA CALEFACCIÓN, AIRE ACONDICIONADO, A.C.S. Y VAPOR DE BAJA PRESIÓN  
 PRETENSADOS DE FÁBRICA**

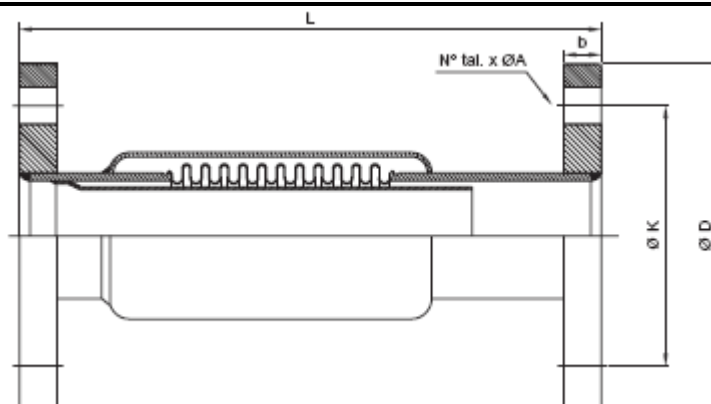

DN	Ø	PN	CARRERA (mm)	L	D	K	b	Nº taladros	REFERENCIA
½"	15	16	-30	240	95	65	14	4	AF0001016015
¾"	20	16	-30	240	105	75	16	4	AF0001016020
1"	25	16	-30	240	115	85	16	4	AF0010160025
1 ¼"	32	16	-30	250	140	100	16	4	AF0001016032
1 ½"	40	16	-30	250	150	110	16	4	AF0001016040
2"	50	16	-30	280	165	125	18	4	AF0001016050